

**BNC Panel Crimp Socket For RG174 RG316 RG188 GBC100**

Part number: 305-408

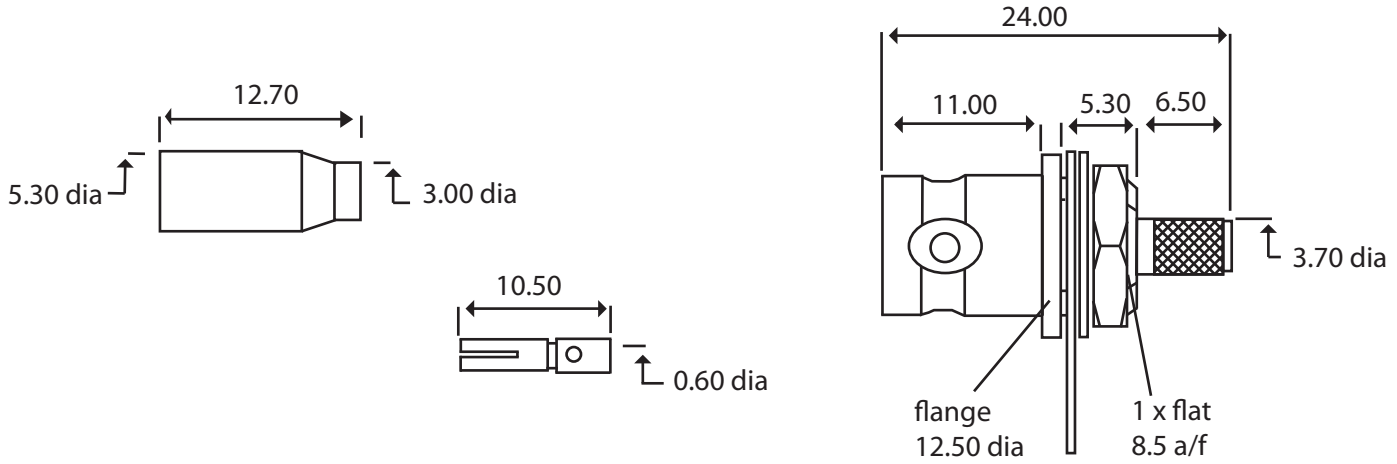

**Description BNC Crimp Panel Mount Jack - Front Entry**

<b>To Fit Cable Types</b>	RG174, RG188, RG316, GBC 100
<b>Fixing Method</b>	Crimp
<b>Body</b>	Brass, Nickel Plated
<b>Contact</b>	Brass, Gold Plated
<b>Dielectric</b>	PTFE
<b>Ferrule</b>	Brass, Nickel Plated
<b>Locknut</b>	Brass, Nickel Plated
<b>Washer</b>	SS41, Nickel Plated
<b>Cable Retention</b>	Equal to breaking strain of cable
<b>Dielectric Withstanding</b>	1500 Volts RMS Maximum
<b>Durability</b>	500 mating cycles
<b>Impedance</b>	50 ohms
<b>Max. Frequency</b>	4 GHz
<b>Temperature Range</b>	-65 to +165 degrees C
<b>Working Voltage</b>	500 Volts RMS Maximum

