

## SMA Straight Crimp Socket (50 Ohm) For LMR240, GBC240

Part number: 311-501

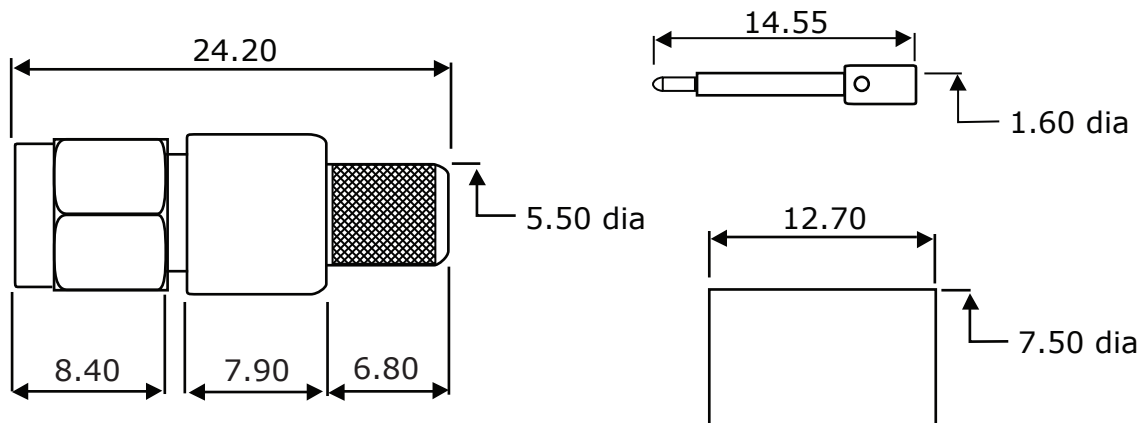

Description	SMA Crimp Plug, Nickel Plated
To Fit Cable Types	LMR240 and GBC240
Fixing Method	Crimp
Body	Brass, Nickel Plated
Dielectric	PTFE
Ferrule	Brass, Nickel Plated
Pin	Brass, Gold Plated
Cable Retention	Equal to breaking strain of cable
Durability	500 mating cycles
Impedance	50 ohms
Max. Frequency	12.4 GHz
Temperature Range	-65 to +165 degress C
Working Voltage	500 Volts RMS