

Type 43 Standard Density STD43 Straight QT Plug For BT3002,TZC75024
Part Number : 316-402

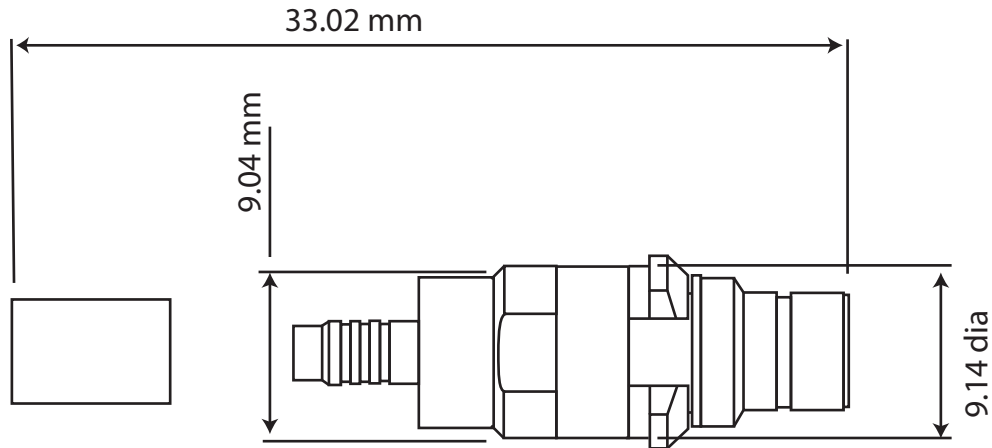

| Electrical | |
|-------------------------------------|-----------------------------|
| Impedance | 75Ω nominal |
| Frequency Range | 0 to 3.0 |
| Working Voltage | 500V |
| Proof Voltage | 1500V |
| Insulation Resistance | 5GΩ min |
| Center Contact Resistance | 5.0m Ω max |
| Outer Contact Resistance | 1.0mΩmax |
| Current Rating | 1.5 A dc max |
| Materials | |
| Body Components | Copper or Zinc alloy |
| Center Contacts(Male/Female) | Copper alloy |
| Insulators | PTFE or Thermo set Plastics |
| Crimp Ferrules | Annealed Copper alloy |
| Finishing/Plating | |
| Center Contacts | Gold |
| Outer Contacts | Gold |